

CLARESHOLM, Christ the King (formerly St. George's)

MAPS

- 1913 - 1918 Loans, accounts. Moving church.
- 1937 - 1941 1937 Report.  
Correspondence, Bishop Carroll - Redemptorists, re taking charge  
of parish. Arrangements for car, house, etc.  
Rev. Thos. Coyne, C.Ss.R. pastor.
- 1942 - 1944 House opening; debt; old wine acct.; Fr. Coyne moved, Fr. J. Lambert  
C.Ss.R., pastor. Garage. Debt statement Nov. 1944  
Rev. N. Killingsworth C.Ss.R. pastor.
- 1945 - 1947 Fire claim. Heating. Care of RCAF after War. Rev. A. Steockel, PP  
Blessed Sacrament reservation at Granum. Boundaries,  
Addendum to 1946 Report. Renovations planned.  
Redemptorists leaving. Rev. P. B. O'Byrne, PP, May 1, 1947.  
Fr. P. O'Byrne's prospective plans (2 letters)  
\$5,000 gift, J.J. Bell
- 1948 - 1956 Fr. O'Byrne - Bishop Carroll, correspondence.  
John Fetherston  
Addition to rectory. Increased cost of same; loans  
Semi-public chapel. Loans statement.  
Bell fund statement.  
Nanton church repairs.  
School attempts.  
Fr. O'Byrne's summary. Investing funds.
- 1957 Rev. F. MacKay, pastor. Confirmation.  
RCAF Chapel. Fr. Cooney replaces Fr. Welsh as curate.
- 1962 - 1965 Fr. Mongeau, P.P.  
Demolishing old church  
Approval plans of new church. Specifications  
Contract \$65,000.00  
New church simple blessing, (title Christ the King), by Fr.  
Mongeau, Dec. 25, 1962.  
Changes in curates.  
Bishop Carroll solemnly blesses church July 7, 1963.
- 1966 - 1967 Changes in sanctuary, Nanton and Clareholm.  
Fr. Scott  
Medal Bene Merenti for Thos. Riddell.  
Fr. Tansey, assistant.  
Assessment protest.  
Holidays ( Bishop Klein)  
Car expenses approved.



PROVINCIAL ARCHIVES OF ALBERTA	
ACC.	72.130

ESTIMATE

# McDOUGALL & McMAHON LIMITED

LOCAL DEALERS  
LUMBER AND BUILDING MATERIAL OF ALL KINDS  
GRANUM, ALTA.

This Material used on Sec. .... T<sub>h</sub> .... R<sub>ce</sub> .... W. .... M. ....

No. Pieces	Description	PL	Price	Total
	<b>Clarebela</b>			
	Mr. Belles			
	Mr. Vadnais.			
	Mr. Dinkmeir.			
	Mrs. Linden.			
	Mrs. Rose.			
	K. Braron.			
	F. Downs.		X	
	J. Dunn.		X	
	J. Schuermacher.			
	A. Sharples.			
	H. Sharples.			
	AMcDonald.			
	Mr. Morkgh.			
	Mr. Jacobsen.			
	C. F. A. Leeds.			
	Mr. Barry.			
	J. Bowie.			
	Mr. Butts.			
	Mr. Labutte.			
	Mr. Waigle.			
	W. J. Cochlin.			
	J. Murphy.			

I hereby agree to accept at prices quoted .....

We hereby agree to deliver at prices quoted .....



# ESTIMATE

## McDOUGALL & McMAHON LIMITED

LOCAL DEALERS  
LUMBER AND BUILDING MATERIAL OF ALL KINDS  
GRANUM, ALTA.

This Material used on Sec. .... Tp. .... Rce. .... W. .... M. ....

No. Pieces	Description	Ft.	Price	Total
	<b>Stavely.</b>			
	F. Heidmiller.	"		
	W. H. Muckenhirn.	"		
	J. Muckenhirn.	"		
	A. Muckenhirn.	"		
	D. Schutefski.	"		
	J. Schlessor.	"		
	B. Bester.	"		
	J. Schuermacher.	"		
	O. H. James.	"		
	Mr. Leangel.	"		
	Mr. Lenora.	"		
	R. Lavergne. *	"		
	Mr. Caroman.	"		
	W. Bush.	"		
	B. McChaney.	"		
	S. McDonald.	"		
	J. McDonald.	"		
	D. J. McMillan.	"		
	J. Hughes.	"		
	H. Erwin.	"		
	J. F. Grumley.	"		
	J. Collins.	"		
	E. B. Clancy.	"		
	J. W. Dulles.	"		
	H. Boyle.	" Parkbench		
	Mr. Reis.	"		
	L. Reis.	" Parkbench		
	Mr. Chesty * x	"		
	Harold Hynes Teacher Pitt Caulee			

I hereby agree to accept at prices quoted

We hereby agree to deliver at prices quoted



THE EAST INDIA COMPANY LIMITED



*[Faint, illegible handwritten text]*



# ESTIMATE

## McDOUGALL & McMAHON LIMITED

LOCAL DEALERS  
LUMBER AND BUILDING MATERIAL OF ALL KINDS  
GRANUM ALTA

This Material used on Sec. .... Tp. .... Rge. .... W. .... M. ....

No.	Name	Description	Qty.	Price	Total
		Granum.			
	L. Cochlin	"			
	D. D. Farmer	A X			
	T. J. Dolan	"			
	R. McDougall	"			
	A. McDougall	"			
	T. Cochlin	"			
	D. J. McMahon	"			
	J. H. Swain	"			
	J. H. Boyle	"			
	D. A. Boyle	"			
	J. H. Boyle	"			
	H. Ifleur	"			
	H. Matty	"			
	J. Darnat	"			
	W. McMahon	"			
	J. Jaffeway	" X			
	P. Jaffeway	"			
	J. L. Hatten	"			
	L. Pfefferle	" X			
	M. Smith	"			
	M. Murphy	"			
	M. Murphy	"			
	P. Deman	"			
	F. Venne	"			
	A. Demere	"			
	L. Miller	" X			
	M. Donahue	" X			
	J. Cochlin	"			
	J. Daly	"			
	F. Daly	"			

I hereby agree to accept at prices quoted

We hereby agree to deliver at prices quoted



ESTIMATE  
SHEWAN TOMES & CO. LIMITED





# ESTIMATE

## McDOUGALL & McMAHON LIMITED

LOCAL DEALERS  
LUMBER AND BUILDING MATERIAL OF ALL KINDS  
GRANUM ALTA

This Material used on Sec. \_\_\_\_\_ T<sub>h</sub> \_\_\_\_\_ R<sub>ge</sub> \_\_\_\_\_ W<sub>ys</sub> \_\_\_\_\_

No. Price	Description	Ft	Price	Total
	<b>Nanton.</b>			
	H. Coughlin.	"		
	P. Coughlin.	"		
	F. Coughlin.	"		
	C. Coughlin.	"		
	W. F. Kirchoff.	" X		
	J. M. Hughes.	" X		
	W. C. Ebbert.	"		
	J. O. Fetherston.	"		
	Mr. Downe.	" <i>Calley</i>		
	MR. Little.	"		
	Mr. Leventure.	"		
	Mr. Declare.	"		
	W. P. Kinney.	" X		
	R. Delahunty.	" X		
	MR. Myrtha.	"		
	Mr. Duffy.	" <i>Calley</i>		
	<i>D. COUGHLIN</i>			

I hereby agree to accept at prices quoted .....

We hereby agree to deliver at prices quoted .....

STAMPS

5 MEMORANDUM



# Clareholm and Missions

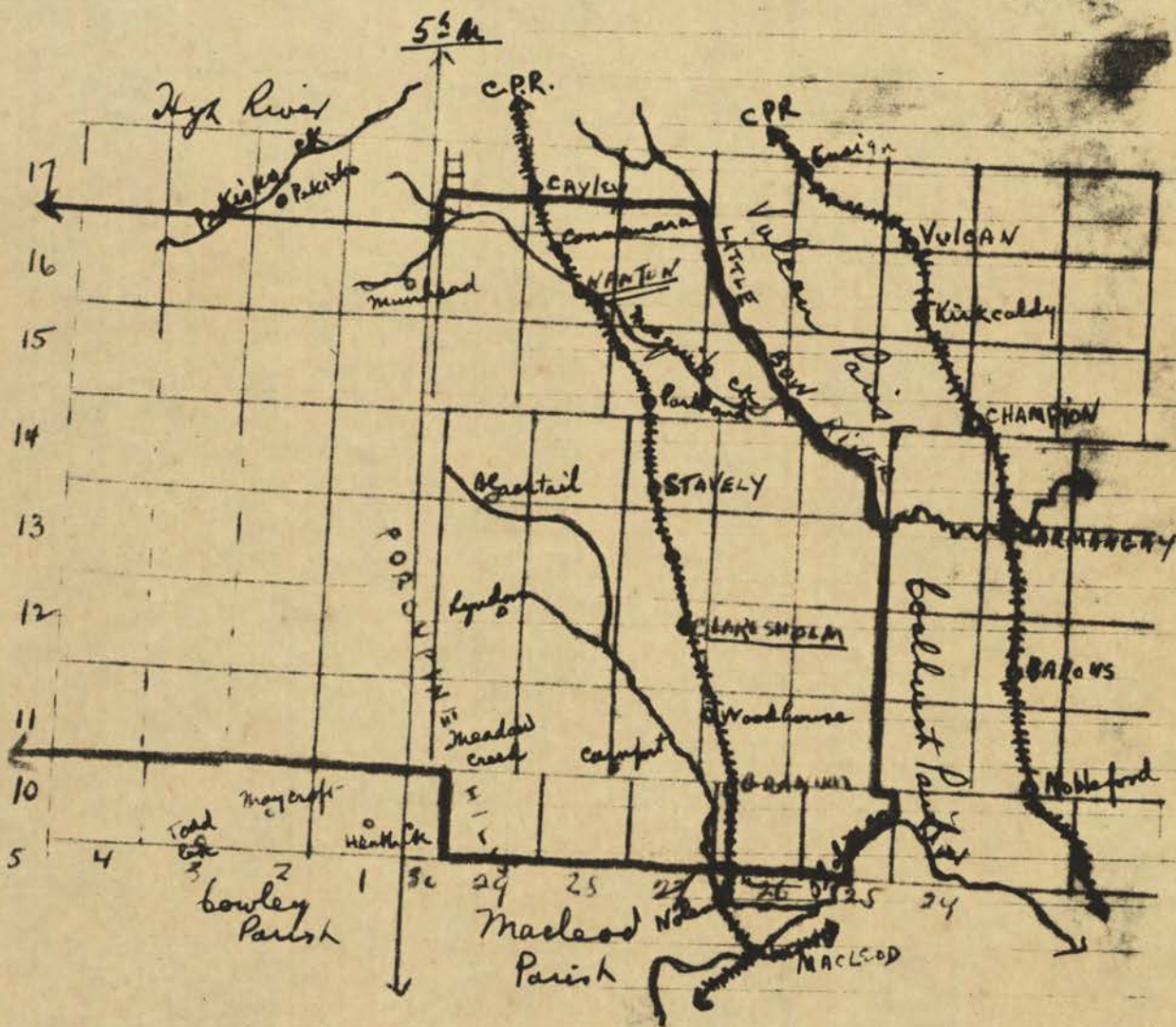







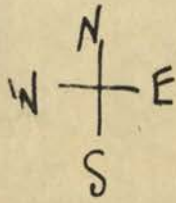

HIGH RIVER.

○  
↓ 20 miles

○ CAYLEY

↓ 8 miles

○ ONANTON

↓ 17 miles

○ STAYELY.

○ CLARESHOLM

CLARESHOLM-  
PARISH  
and  
MISSIONS

↓ 11 miles  
○ GRANLIM.

↓ 14 miles  
○ MACLEOD

BRITISH COLUMBIA

ALBERTA.





# Clareholm and Missions

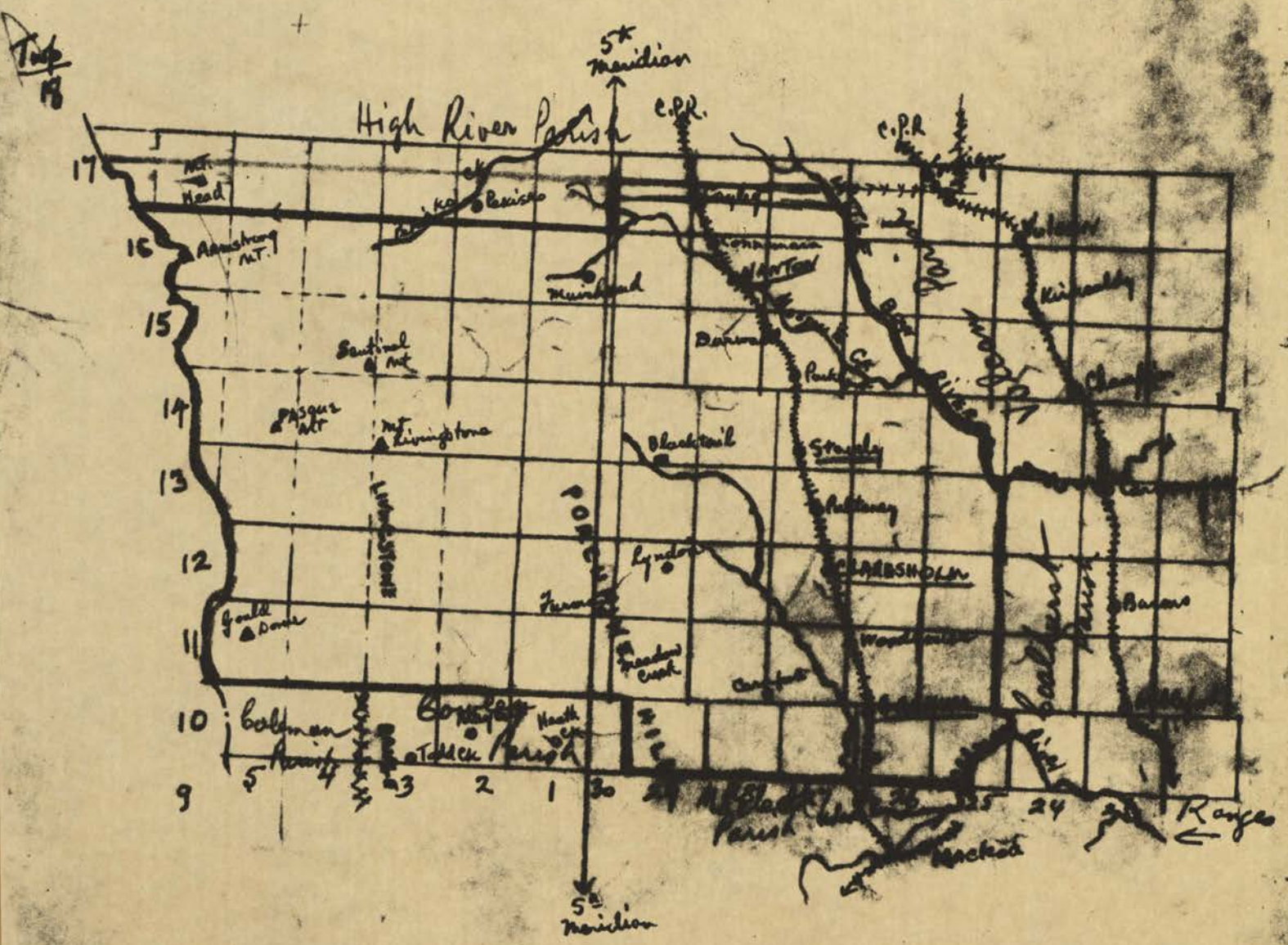



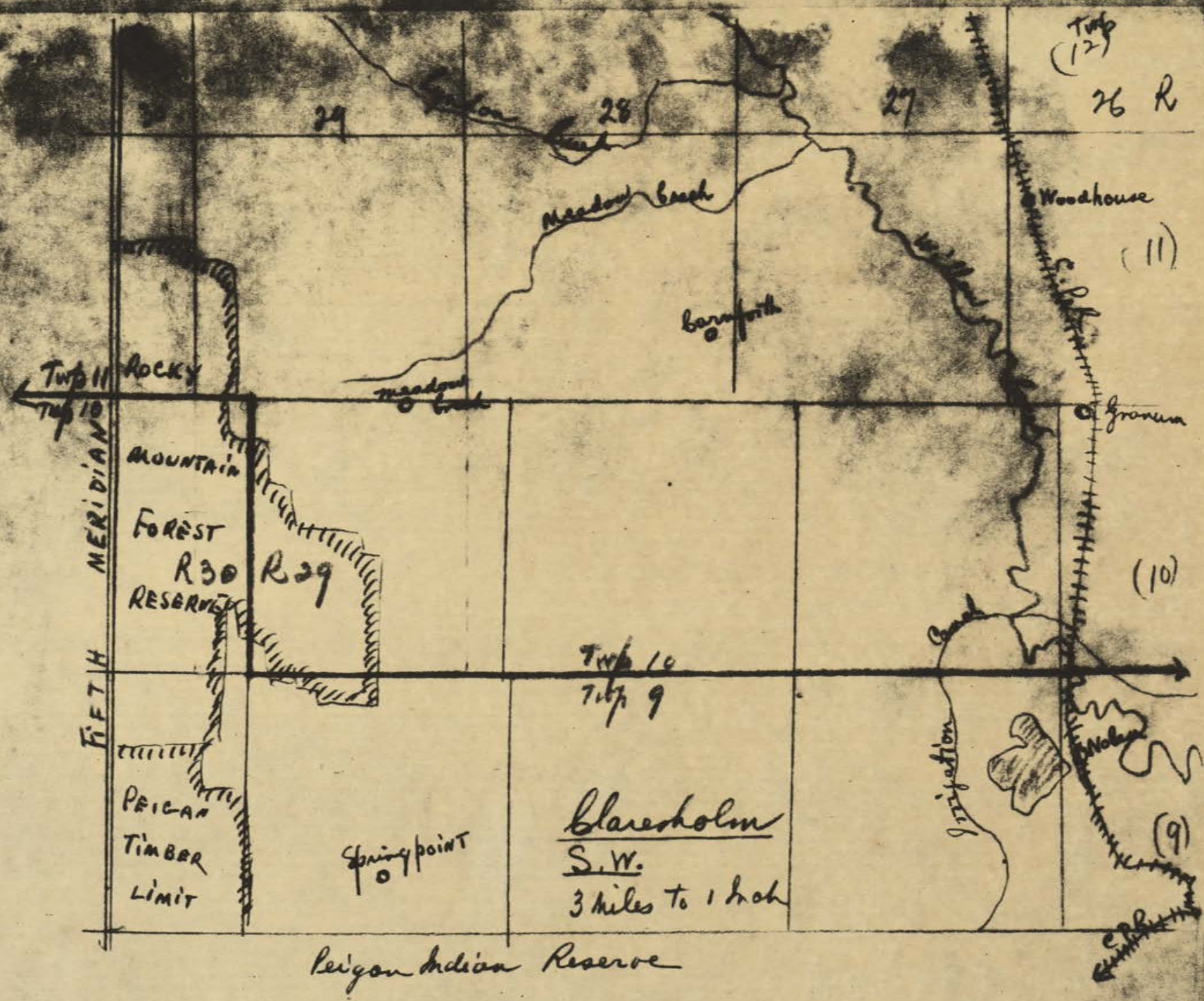

Reigon Indian Reserve



Clareholm

N. E. 3 miles to 1 inch

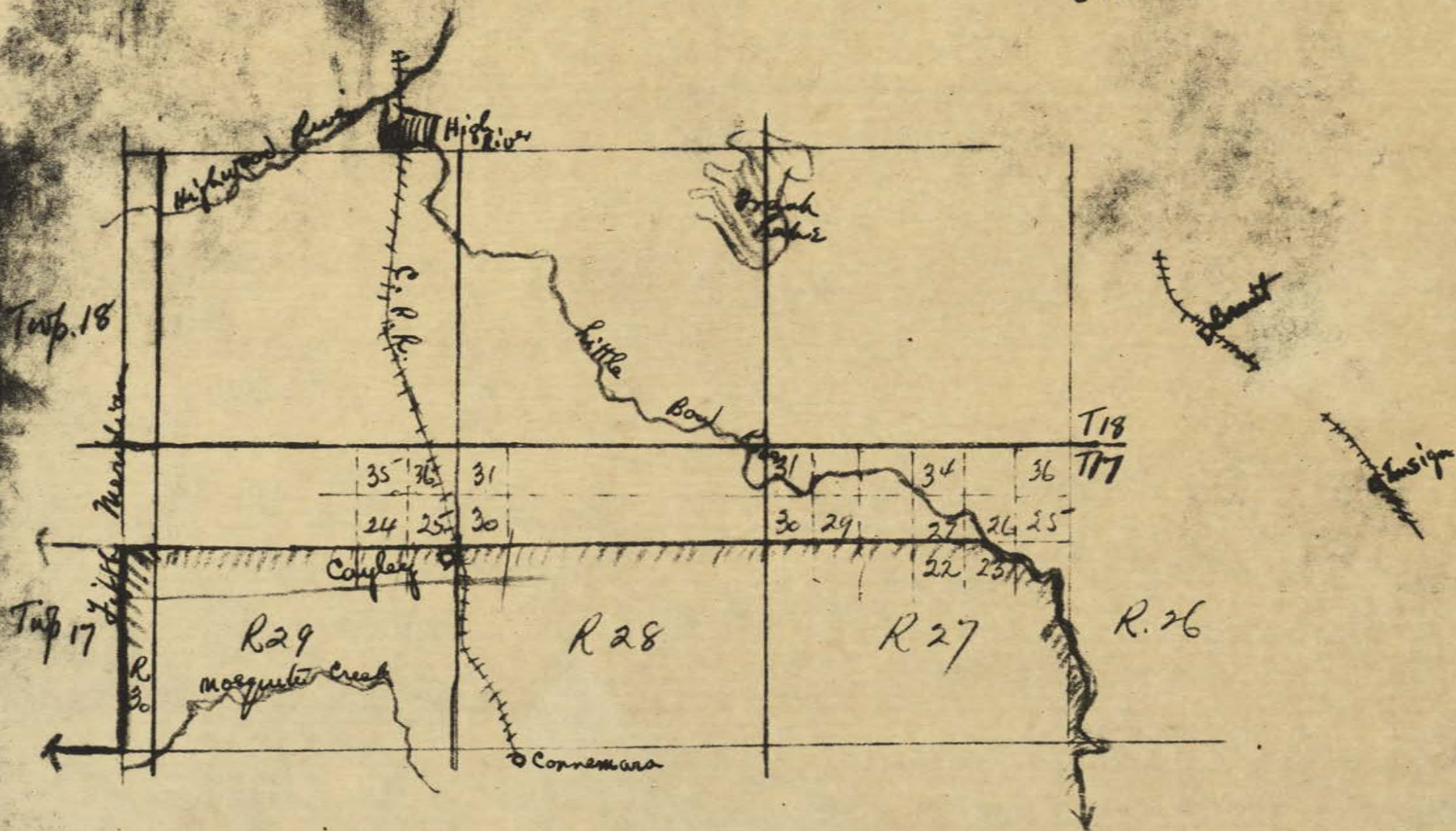



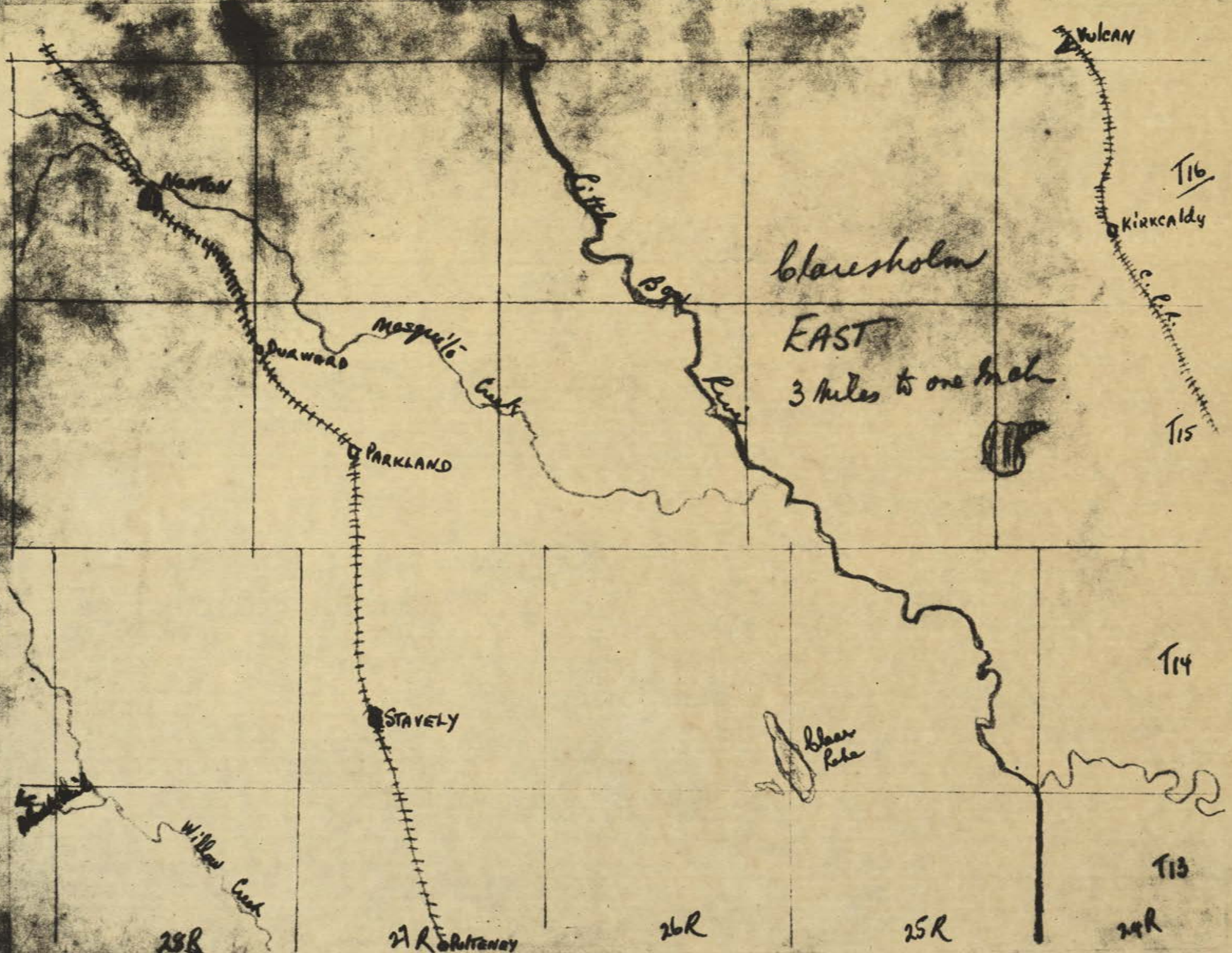

Naughton

Vulcan

T16

Kirkcaldy

Blaesholm

EAST  
3 miles to one inch

T15

Duawood

Masquillo  
Creek

PARKLAND

STAVELY

Blaer  
Lake

T14

Willow  
Creek

T13

28B

27R  
ROBTENNY

26R

25R

24R





# Charesholm

**Eastern Boundary:** Beginning at the Oldman River, the line between the 24<sup>th</sup> & 25<sup>th</sup> <sup>Ranges</sup> Ranges, northward to the Little Bow River, northwards and westward, on the Little Bow River, to the line between the 23<sup>rd</sup> and 24<sup>th</sup> sections, Twp. 17 Range 27 west of the 4<sup>th</sup>.

**Northern Boundary:** Beginning at the Little Bow River, the line between the 23<sup>rd</sup> & 24<sup>th</sup> sections (i.e. ~~the 23<sup>rd</sup> & 24<sup>th</sup> sections~~ <sup>the 5<sup>th</sup> meridian</sup> sections south of the line between Twp. 17 & 18) westward ~~to the B.C. border~~ <sup>to the line between the 17<sup>th</sup> & 16<sup>th</sup> Twp.</sup> westward on it to the B.C. border.

**Western Boundary:** Beginning at the last named line, the B.C. border southward to the line between the 11<sup>th</sup> & 10<sup>th</sup> Twp.

**Southern Boundary:** Beginning at the B.C. border, the line between the 11<sup>th</sup> and 10<sup>th</sup> Twp eastward to the line between the 30<sup>th</sup> and 29<sup>th</sup> Ranges (west of the 4<sup>th</sup> meridian) southward on it to the line between the 10<sup>th</sup> and 9<sup>th</sup> Twp; eastward on it to the Oldman River; north and east on the River to the line between the 25<sup>th</sup> & 24<sup>th</sup> Ranges.



PROVINCIAL ARCHIVES OF ALBERTA
ACC. 72.130